

S200 Series

CENTRIFUGAL PUMPS

APPLICATION

Designed for use in the pharmaceutical industries, these pumps feature the standard benefits of the traditional 200 Series centrifugals plus are manufactured to ASME BPE specification criteria. All product contact components are machined from wrought <5% ferrite level, 316L SS, and feature a 20 Ra product contact surface finish. Material heat numbers are available on all product contact components.

MODELS

S2045, S2065, S2065HV, S2065LV, S2075, S2085, S2085LV, S2092

STANDARD FEATURES

- Designed to be Cleanable-in-Place (CIP)
- High Efficiency, low NPSHR design for a wide variety of applications
- One size mechanical seal used in all 200 Series models for reducing parts inventory and cost
- Integral impeller/shaft design for fewer parts, greater concentricity, easy maintenance, and less overhung load
- Close coupled pumps use NEMA JM Frame motors with larger diameter shafts and bearings compared to C Frame motors
- Impellers, casing, and backplate are machined from wrought 316L SS
- Cast iron Nedox® coated cast iron motor adaptors
- FDA approved fluoroelastomers

SPECIAL FEATURES

- Manufactured to ASME BPE specification criteria
- All product contact components machined from wrought, <5% ferrite level, 316L SS
- 20 Ra product contact surface finish
- Material heat numbers on all product contact components

OPTIONAL

- | | | |
|---|---------------------------|---|
| ▪ 15 Ra, electropolish, and passivation of product contact surface finishes | ▪ Commercial seal options | ▪ SS Leg Kits |
| ▪ WFI (Water For Injection) shaft seal design | ▪ Casing drain | ▪ Ra Mapping |
| ▪ Double mechanical seals | ▪ USP Class VI elastomers | ▪ Certified and witness performance testing |
| | ▪ 304 SS motor adaptors | ▪ Frame mounted pumps |
| | ▪ Stainless steel motors | ▪ Stainless steel bases and coupling guards |



**Close coupled Model
S2065LV with optional SS
Motor, Adapter and
Leg Kit shown.**



**All Wet-end components are made from
wrought 316SS, (UNS 31603) bar or flat
stock with composition and manufacturing
process controls that limit delta ferrite
content to less than 5%.**

S200 Exploded View

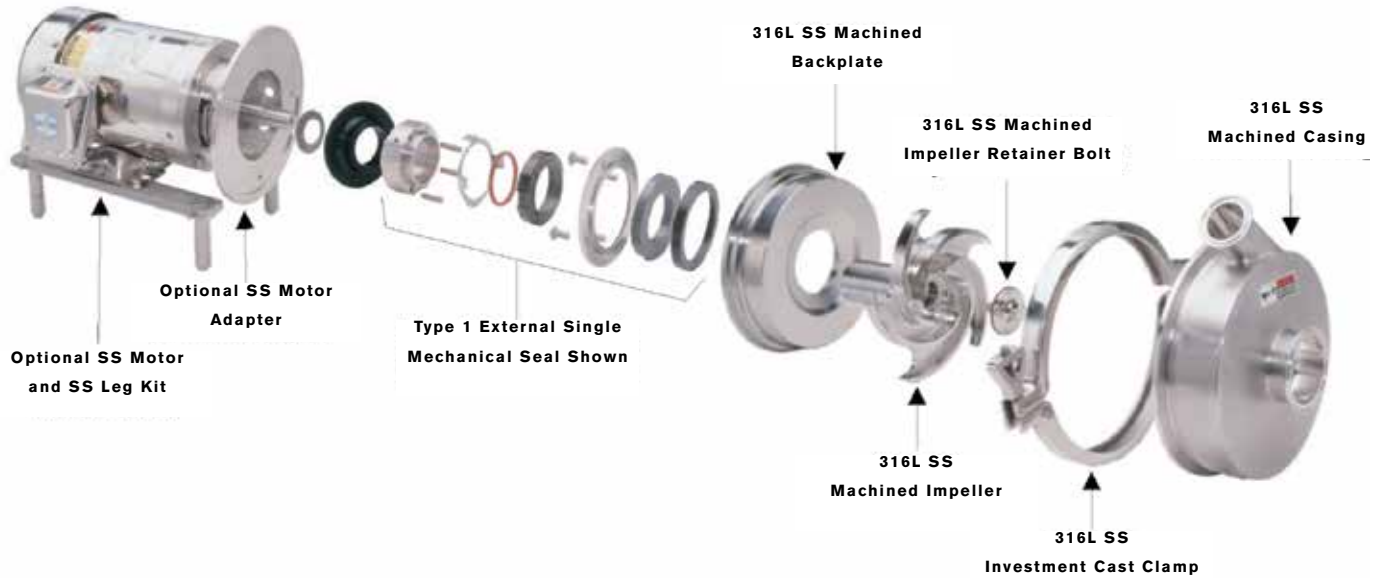

| MODEL | INLET SIZE INCHES (mm) | | OUTLET SIZE IMPELLER SIZE INCHES (mm) | MAXIMUM IMPELLER SIZE INCHES (mm) | MAXIMUM CAPACITY GPM (M ³ /HR) | | MAXIMUM HEAD FEET FEET (METERS) | |
|---------|------------------------------|--------------|--|--|---|--------------|---------------------------------------|--------------|
| | | | | | 1750 RPM | 3500 RPM | 1750 RPM | 3500 RPM |
| S2045 | 1.5 (40) | 2.0 (50) | 1.5 (40) | 4.5 (114) | 97 (22) | 190 (43) | 22 (6) | 88 (27) |
| S2065LV | 1.5 (40) | 2.5 (65) | 1.5 (40) | 6.5 (165) | 100 (23) | 195 (44) | 44 (13) | 173 (53) |
| S2065 | 2.5 (65) | | 2.0 (50) | 6.5 (165) | 245 (56) | 450 (102) | 46 (14) | 180 (55) |
| S2065HV | 3.0 (75) | | 2.0 (50) | 6.5 (165) | 230 (52) | 500 (114) | 44 (13) | 180 (55) |
| S2075 | 3.0 (75) | | 1.5 (40) | 8.7 (221) | 125 (28) | 300 (68) | 79 (24) | 320 (97) |
| S2085 | 3.0 (75) | 4.0 (100) | 2.5 (65) | 8.7 (221) | 490 (111) | 900 (204) | 80 (24) | 312 (95) |
| S2085LV | 2.0 (50) | | 1.5 (40) | 8.7 (221) | 70 (16) | 140 (32) | 81 (24) | 310 (94) |
| S2092 | 3.0 (75) | | 2.0 (50) | 9.25 (235) | 380 (86) | 700 (159) | 90 (27) | 362 (110) |



Based in Charlotte, North Carolina, SPX FLOW, Inc. (NYSE: FLOW) is a multi-industry manufacturing leader. For more information, please visit www.spxflow.com

SPXFLOW

SPX FLOW 611 Sugar Creek Road, Delavan, WI 53115

P: (262) 728-1900 or (800) 252-5200, F: (262) 728-4904 or (800) 252-5012

E: wcb@spxflow.com • www.spxflow.com

SPX FLOW, Inc. reserves the right to incorporate our latest design and material changes without notice or obligation.

Design features, materials of construction and dimensional data, as described in this bulletin, are provided for your information only and should not be relied upon unless confirmed in writing. Please contact your local sales representative for product availability in your region. For more information visit www.spxflow.com.

The green "S" and "X" are trademarks of SPX FLOW, Inc.

ISSUED 02/2016 DS-1301

COPYRIGHT © 2016 SPX FLOW, Inc.